

24 Industrial Park Circle, 20140414.dwg, Model: 20140414.dwg, 3/16" = 1'-0", 3/16" = 1'-0"

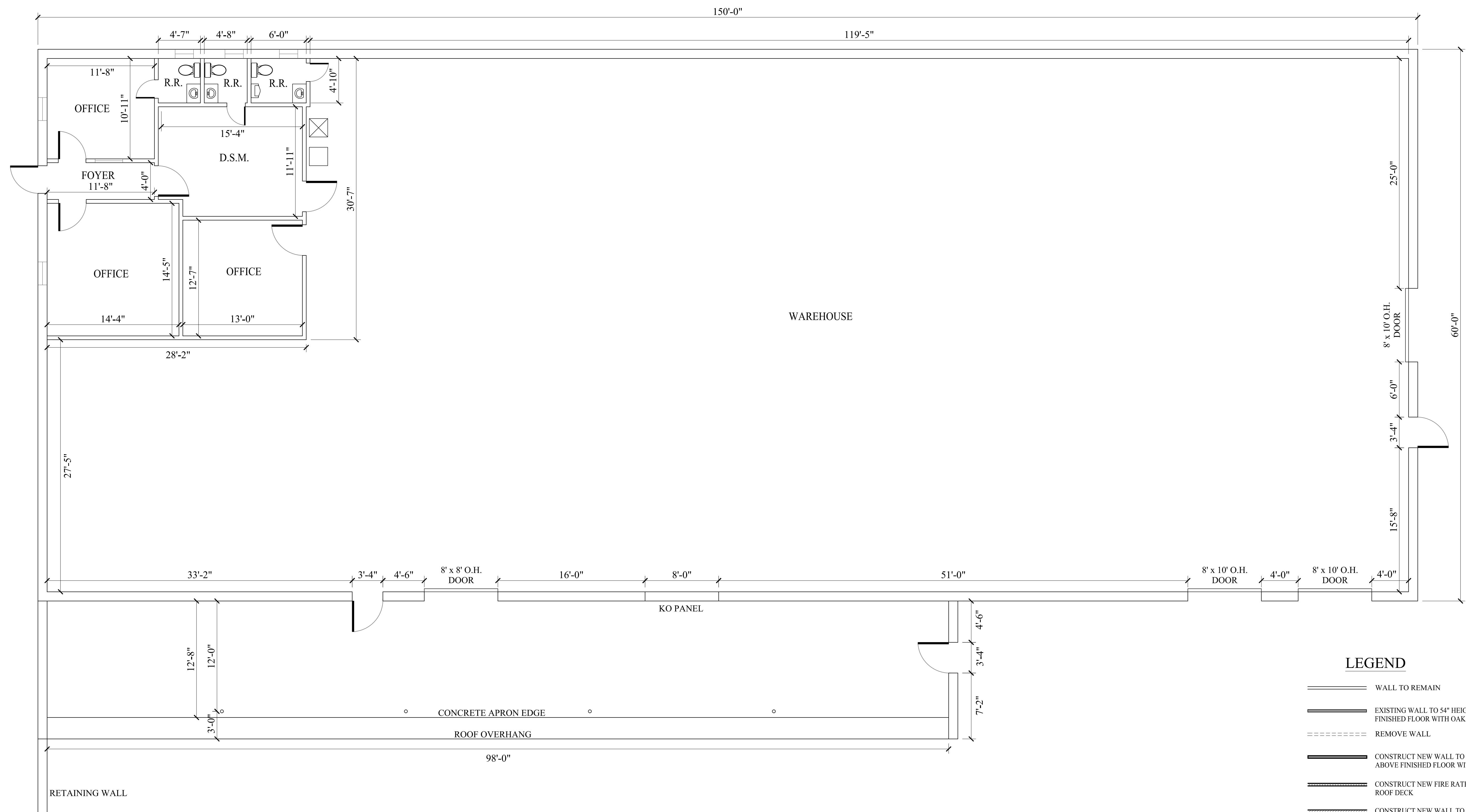

FLOOR PLAN  
SCALE: 3/16" = 1'-0"

**LEGEND**

- ===== WALL TO REMAIN
- ===== EXISTING WALL TO 54" HEIGHT ABOVE FINISHED FLOOR WITH OAK CAP
- - - - - REMOVE WALL
- ===== CONSTRUCT NEW WALL TO 54" HEIGHT ABOVE FINISHED FLOOR WITH OAK CAP
- ===== CONSTRUCT NEW FIRE RATED WALL TO ROOF DECK
- ===== CONSTRUCT NEW WALL TO 10'-0" ABOVE FINISHED FLOOR
- WATER CLOSET
- URINAL
- SINK
- ⊠ FIBERGLASS UTILITY TUB
- DRINKING FOUNTAIN

<b>VANGUARD</b> E n g i n e e r i n g P C		2411 Castletobar Road, Rochester, New York 14610 585.427.0320 phone • 585.861.6799 facsimile www.vaneng.com	
DRAWING ALTERATION THE FOLLOWING IS A CONCEPTUAL DRAWING. IT IS NOT INTENDED TO BE USED FOR CONSTRUCTION. IT IS THE RESPONSIBILITY OF THE CLIENT TO VERIFY THE ACCURACY OF THE INFORMATION PROVIDED. VANGUARD ENGINEERING PC DOES NOT WARRANT THE ACCURACY OF THE INFORMATION PROVIDED. IT IS THE RESPONSIBILITY OF THE CLIENT TO VERIFY THE ACCURACY OF THE INFORMATION PROVIDED. VANGUARD ENGINEERING PC DOES NOT WARRANT THE ACCURACY OF THE INFORMATION PROVIDED.			
Scale	3/16" = 1'	Sheet No.	1 OF 1
Date	10/08/2012	Client	GALLINA DEVELOPMENT CORPORATION 1890 SOUTH WINTON ROAD, SUITE 100, ROCHESTER NEW YORK 14618
Job No.	201204.14	Project	24 INDUSTRIAL PARK CIRCLE TOWN OF GATES, NEW YORK
Designed by	JCA	Drawing	FLOOR PLAN
Drawn by	JCA		
Checked by	JCA		
Approved by	JCA		
		REVISIONS	