

GENERAL CONDITIONS

- PERFORM SELECTIVE DEMOLITION WORK IN A SYSTEMATIC MANNER. USE SUCH METHODS TO AVOID COLLAPSE OF EXISTING STRUCTURE. ACCORDANCE WITH GOVERNING REGULATIONS, REPAIR DEMOLITION WORK IN EXCESS OF THAT REQUIRED. RETURN STRUCTURE AND SURFACES TO ORIGINAL FINISHES. REPAIR ADJACENT CONSTRUCTION OR SURFACES SOLED OR DAMAGED BY SELECTIVE DEMOLITION WORK.
- CONTRACTOR SHALL INSURE ALL WORK IS IN CONFORMANCE WITH ALL APPLICABLE BUILDING CODES AND REGULATIONS. ALL WORK SHALL BE COMPLETED IN STRICT ACCORDANCE WITH ALL APPLICABLE BUILDING CODES, N.Y.S. UNIFORM FIRE PREVENTION AND BUILDING CODE, N.Y.S. ENERGY CONSERVATION CODE, N.Y.S. PLUMBING CODE, NATIONAL ELECTRICAL CODE, INTERNATIONAL MECHANICAL, STATE, AND LOCAL AGENCY REGULATIONS. HAVING JURISDICTION OVER THIS PROJECT. IN THE EVENT OF ANY DISCREPANCIES BETWEEN THE DRAWINGS AND EXISTING CONDITIONS, THE CONTRACTOR SHALL OBSERVE THE MORE STRINGENT REQUIREMENTS.

MEP DESIGN BUILD NOTES

OWNER TO PROVIDE / COORDINATE HVAC & ELECTRICAL ON A DESIGN BUILD BASIS IN ACCORDANCE WITH ALL APPLICABLE BUILDING CODES. MODIFY EXISTING MECHANICAL AND ELECTRICAL REQUIRED FOR WALL DEMOLITION AND NEW WALL CONSTRUCTION.

GENERAL NOTES

- WALL THICKNESS IS DIMENSIONED NOMINALLY. ALLOW FOR ACTUAL VS. NOMINAL DIMENSION DIFFERENCE WHEN WALLS ARE LAID OUT.
- CONTRACTOR SHALL VERIFY ALL DIMENSIONS IN FIELD PRIOR TO CONSTRUCTION AND NOTIFY ARCHITECT OF ANY DISCREPANCIES ON DRAWINGS.
- FINISH SELECTIONS TO BE COORDINATED BETWEEN TENANT AND LANDLORD.

PARTITION TYPES

- A** 2-5/8" METAL STUD PARTITION
25GA. 3-5/8" METAL STUDS @ 16" ON CENTER. FLOOR AND CEILING RUNNERS. WALL TIGHT TO DECK ABOVE. ONE LAYER 5/8" TYPE 'X' GYPSUM BOARD EACH SIDE OF WALL TO EXTEND 6" ABOVE CEILING GRID.

RCP GENERAL NOTES

- MODIFY EXISTING ACOUSTICAL TILE CEILING, LOCATIONS AS REQUIRED FOR WALL DEMOLITION AND NEW WALL CONSTRUCTION.
- WHERE EXISTING LIGHT FIXTURES TO REMAIN, CLEAN AND RELAMP AS REQUIRED.
- EXISTING EXIT LIGHTS TO REMAIN.

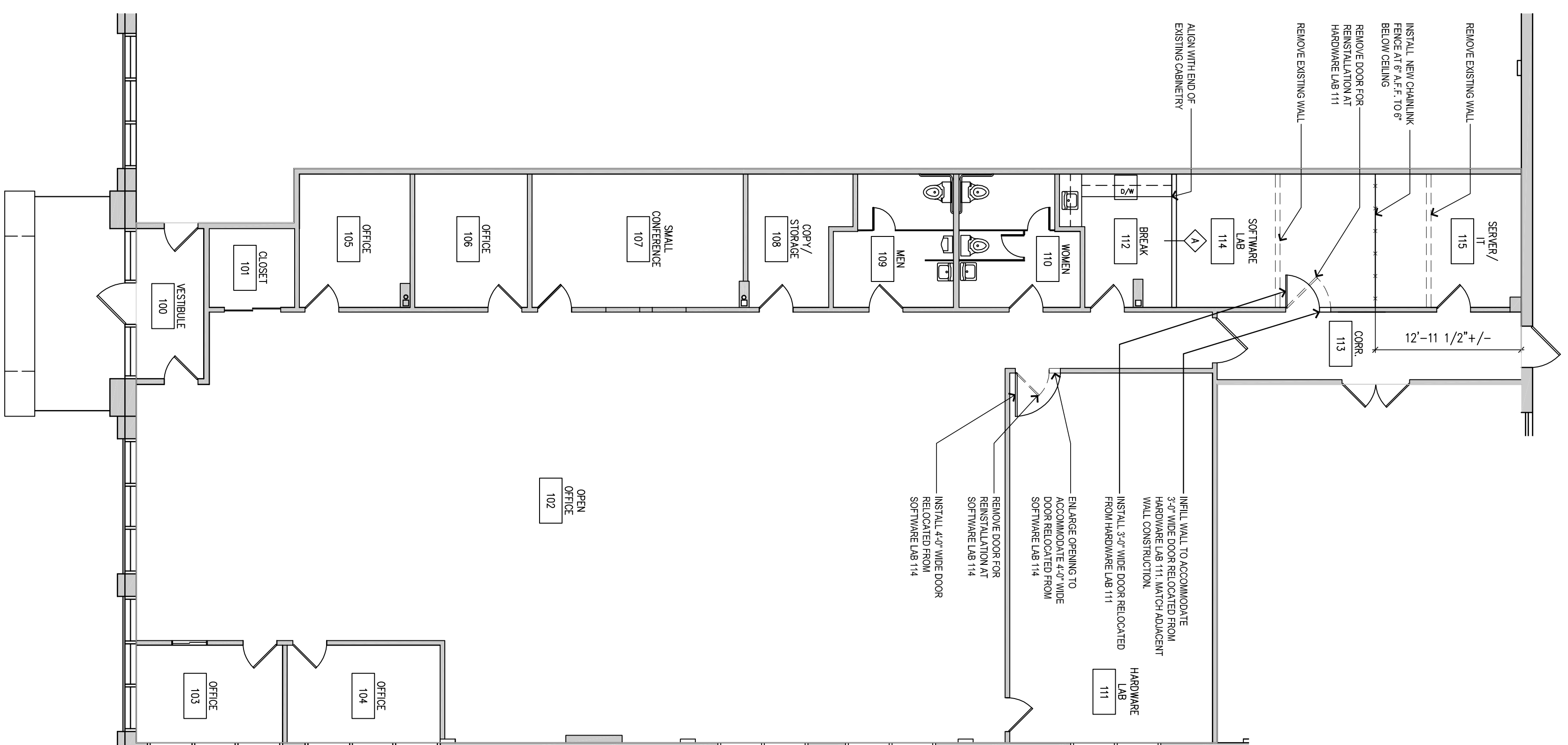

1 FLOOR PLAN
SCALE: 1/8" = 1'-0"

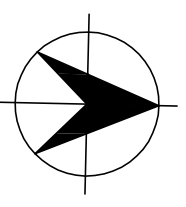

Kelly Jahn
interior architecture
& DESIGN

274 Auditor Drive
Rochester, NY 14618
P 585.354.2788
email: Kelly@kellyjahn.com

Gallina DEVELOPMENT CORPORATION

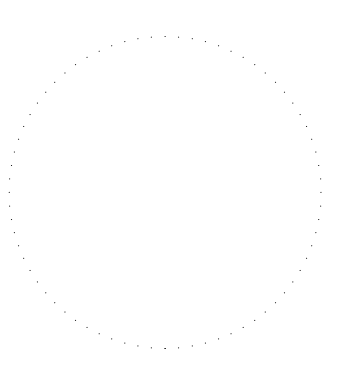

This is a violation of Title VIII, Article 47 of NYC Education Law for any person, unless acting under the direction of a licensed architect, who alters this document in any way. Any licensee who alters this document is required by law to affix his signature and a specific description of the alterations made.

Title
3500 WINTON PLACE
SUITE 4 - SONUS
ROCHESTER, NY 14623

PERMIT DRAWINGS

Kelly Jahn IABD Project No. 0801.14
Date 08/20/2014
Drawn By
Checked By
Scale AS NOTED
Revisions

FLOOR PLAN

DRAWING NUMBER:
A-1